

**SOMETAS**<sup>®</sup> France



Version Number: 2025.12.16

Tel: 400-058-6268

Email: [info@villatas.com](mailto:info@villatas.com)

[WWW.SOMETAS.FR](http://WWW.SOMETAS.FR) [WWW.VILLATAS.COM](http://WWW.VILLATAS.COM)



**SOMETAS**<sup>®</sup>  
Innovation for Life

 **FRANCE  
INNOVATION**

**BF/CF Pro**

**S P L E N D O R**



# COMPANY PROFILE



SOMETAS was founded in 1979 in the southern French city of Valence. For 40 years, SOMETAS has been focusing on elevator development and design, growing into a leading elevator manufacturer in Europe.

Adhere to meet client's needs as the mission, from standard to customization, with strong research and development innovation ability, SOMETAS provides customers with professional customized solutions.

Adhere to the principle of safety and environmental protection design, in line with regulation and standards, strict selection of environmental protection decoration materials, not only to ensure the safety, but also fit the comfortable concept, and won the European premium quality certificate.



Quality, Safety and Environment



Environment

[www.sometas.fr](http://www.sometas.fr)





## Patrice Arnoult

SOMETAS CEO

The leader of lift in France

## Bernard HAUTESERRES

Chief Technical Consultant

50-year experience of elevator  
Senior technical expert in France elevator industry



# GLOBAL TEAM

EMPLOYEES 20000+

An attentive team of lift experts that you can fully trust with your standard or customised projects.



Stephane REAU

Technical director  
CEN member



Claude LECLERC

Electric director



Salvador Jara

Slycma France  
General manager



Philippe.Guillard

Slycma France  
Technical director

# NEARLY 50 YEARS OF SUCCESS STORY

---

## **1972**

Creation of the Company. One of the first founding successes of SLYCMA' s achievement is the PR72 swing door.

## **The 80s**

Slycma innovates, designs and tests its automatic doors. It is the first company to test these doors for several million operations before put on the market, through external laboratories.

## **The 90s**

Because of the safety issue coming more and more, Slycma start to offer adapting landing door and car door for the existing lifts, to provide the solution for modernization.

## **The 2000s**

Slycma become a completely independent industrial company diversifying its activity and developing components that meet the safety functions around doors.

## **The years 2010**

Slycma, while renewing itself, keeps the strong assets: the high level of customization, the ability to manufacture industrially. And Slycma has acquired its own production tools in order to be able to supply flexible solution in shortest time.

## **In 2020**

Slycma strongly enter into the China market, a subsidiary in the same group of sometas, supplying SOMETAS China full range French high quality products: the most advanced auto-folding door, automatic swing door and automatic door and etc.





# HONORS

Innovation Beyond Products.

SOMETAS x Golf.

"Design & Industry Integration" in Action.



# S P L E N D O R

Masterful Craftsmanship, the Epitome of Premium Living

All-round services. Beyond your expectations.





Center-opening auto door

# DOOR OPENING MODE



Swing door



Automatic swing door



Automatic side-opening door



Automatic double swing door

# INSTALLATION ENVIRONMENT

Be available for different space installation requirement

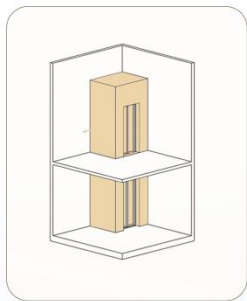

Concrete shaft

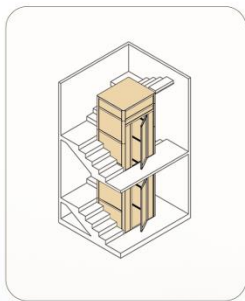

Center of the stairs

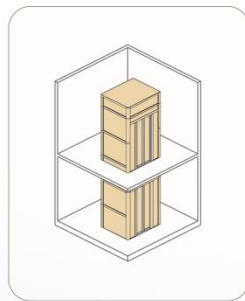

Interior floor openings

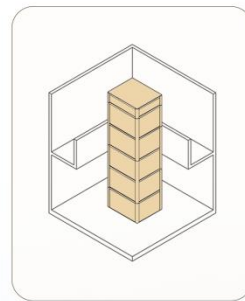

Hollow hall



# 27

## SAFETY DEVICE

### 9

#### Basic configuration with certified

- ① Overspeed governor
- ② Safety gear
- ③ Buffer
- ④ Door lock
- ⑤ Traction machine
- ⑥ Up&down over speed protection system
- ⑦ Electrical safety protection system
- ⑧ Over and stall protection system
- ⑨ Overload protection system

### 9

#### Standard configuration

- ① Full steel core steel rope (made in Germany)
- ② SOS system
- ③ i-Nest system
- ④ ARD
- ⑤ Fault display Intelligent light
- ⑥ Belt broken detection system
- ⑦ Anti-fall machine protection system
- ⑧ Special sealing design
- ⑨ One-click stop/start system

### 9

#### Unique configuration (option)

- ① i-Nest remote call
- ② OTA remote upgrade system
- ③ Touch screen password COP
- ④ Multi-Function buttons
- ⑤ Anti-Epidemic LOP
- ⑥ Self-rescue system
- ⑦ Dual-Button rescue system
- ⑧ Safety notice
- ⑨ Self-rescue function

# FUNCTION OPTION

## Emergency Running Function

### 01

- Holstway Self-learning
- Collective control
- Fault auto- detection function
- Grid power voltage fluctuation detection
- Door reopen signal
- Auto-leveling after inspection
- Floor position intelligent correction
- One-click call
- ARD (STD)
- Position and name record on power off
- Calling cancel in oppsite direction
- Repeated closing door
- Fault data recording
- Parking
- Non-stop setting
- Input port evaluation
- Running time protection

## Operation and Service Function

### 02

- Auto door opening on leveling
- Up/Down hall call buttons
- Door open button
- Door close button
- Auto energy saving function
- Car position and lift status indicator
- Flexible floor setting
- Auto-returning to base floor
- Hall position and lift status indicator
- Opening/closing door button (Automatic door)
- Manually floor selection
- Car Fan
- DIY Floor Display Characters
- i-Nest system (Option)

## Control and Safety Protection Function

### 03

- Inspection running
- Door closing time protection
- Door light curtain protection
- Emergency electrical running of car top and controller
- Speed feedback inspection
- Buffer on pit
- Protection against door-opening outside door zones
- Electrical brake release
- Pre-torque output
- Speed changing on terminal and stop; Floor number adjust
- Low speed self-rescue function on fault
- Protection against safety circuit fault
- Relay checking protection
- Limiting protection
- Up and down limiting protection device
- Brake inspection protection
- Motor overheat protection
- Reversing protection
- Contactor feedback inspection
- Overload without door closing and alarm
- Main contactor and brake contactor paste protection
- Alarm and lighting on power off
- Door closing protection against obstruction
- Manual operation priority on top of car
- Door lock short circuit protection



# i-Nest system

Monitor your private lift

- Check the running status
- Check the lift information
- Check the fault record



# i-Map system

Better service for your customer

- Check the lift map
- Check the lift running status
- Check the fault record
- Speed feedback for lift fault

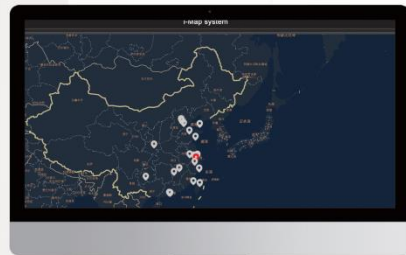

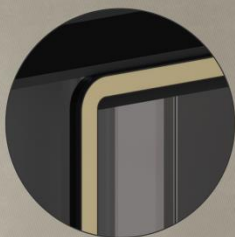

Integrated arc door frame

Frameless door design

Double-glazed design to avoid pinching risks

# DESIGN PHILOSOPHIC



# ERGONOMICS

# AESTHETICS

## All-New frame design



360°observation shaft, hidden design

Glass protrusion from frame profile only 6mm

Hidden frame column design



Concealed column



All-New frame design



360°observation shaft



## Door frame light strip indicator

- Door frame light strip stays on during elevator standby
- Door frame light strip flashes when the elevator is opening/closing
- Door frame light strip turns off when the elevator on energy-saving mode
- blue light strip (Standard)

## Manual swing door handle

Ergonomic design with soft curves, preventing slipping and scratching

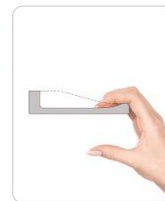

## Double door usage tip

Control method (standard)



Closing both doors together may cause pinch or cut injuries

Control method



Close doors asynchronously: Clamping force direction changes, eliminating cutting and lowering pinching risks



Color options available

# FRAME DECORATIVE PANEL SELECTION

Door frame matches frame color



V-Stst06



V-Stst18



V-Stst20



V-Stst36



V-Stst37



VP003



VP004



VP006



VP007



VP011



VP012



VP033



VP034



VP035



VP036

# LOP collection

## Intelligent sensing

Call-activated red light  
(dim standby)



HB-GL-D21



HB-GR-A14



## COP collection

### Intelligent touch screen

Oversized smart touch screen with rich functions, adjustable ambient backlight, standard Carry all – available in external or built-in installation.

### Adjustable ambient lighting

### Ultra-HD touch screen

### Carry all

All-in-one control: Elevator call, light/ventilation adjustment, emergency self-rescue, one-touch call, and door buttons

### Emergency self-rescue function

1. Activate one-touch call for rescue.
2. Use self-rescue button to re-level.





7-inch LCD display, SOS emergency call button, enabling fault rescue external call and emergency lighting, standard with crystal button Carry all

# COP collection

COP-CH-S11  
(Classic Button)



COP-CH-S12  
(Crystal button)



Bright chrome + diamond inlay  
Light effect: White (standby), pink-purple (touched)



CF100 Pro



## Roller guide shoe

The elevator uses roller guide shoes, with four guide shoes per elevator. Each guide shoe has three rollers for three-dimensional guidance. The rollers have a rubber coating. The system does not require lubrication, unlike elevators with sliding guide shoes that do.



## Host machine Anti-Fall protection

The host has a strong brake to prevent falling when the elevator stops. If the brake falls, the host's short-circuit function will activate, and the PM motor will create resistance to slow down the elevator.

## Full steel core steel rope

Use two 10mm steel core wire ropes, which can carry 20 tons. The car weight and load are about 0.9 tons, so the safety factor is over 20 times.



## ARD

If the lift power off, The ARD device will provide the power to make lift levelling and release the user leaving away from lift safely.

## Speed governor

During lift running, if the speed is up to the limit value, the speed governor will act to make the safety clamp the guide rail and stop the car in the case of other safety protection devices have no effect,





# SPECIFICATION

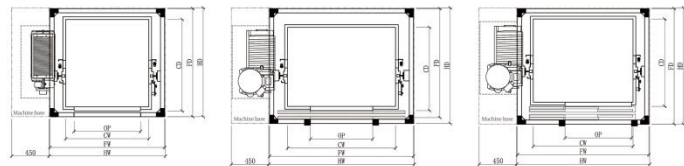

Model	CF110 Pro					CF120 Pro					CF130 Pro					
Shaft type	Aluminum frame															
Opening type	Auto/Manual Swing door					Center opening door					Side opening door					
NO.	1	2	3	4	5	6	7	8	9	10	11	12	13	14	15	
Person	3	3-4		4-5		4-5		5-6		3-4		4-5		5-6		
Area(m <sup>2</sup> )	S	M		L		L		XL		M		L		XL		
	0.5-0.7	0.7-0.9		0.9-1.2		0.9-1.2		1.2-1.6		0.7-0.9		0.9-1.2		1.2-1.6		
Car width(CW)	800	1000			1100		1100		1300		1000		1100		1300	
Car depth(CD)	700	900			1000		1000		1100		900		1000		1100	
Car high(CH)	2200 (High:2100)															
Door opening width	700		800			700		750		700		800				
Door opening height	2000															
Overhead(OH)	3050	2850	3050	2850	3050	2900	3050	2900	3050	2900	3050	2900	3050	2900	3050	
Machine position	Rear	Side	Rear	Side	Rear	Side	Rear	Side	Rear	Side	Rear	Side	Rear	Side	Rear	
Frame width(FW)	1180	1380	1380	1480	1480	1630	1630	1730	1730	1400	1400	1550	1550	1680	1680	
Frame depth(FD)	920	1100	1120	1200	1220	1280	1300	1380	1400	1240	1260	1340	1360	1440	1460	
Shaft width(HW)	1200	1400	1400	1500	1500	1650	1650	1750	1750	1420	1420	1570	1570	1700	1700	
Shaft depth(HD)	930	1110	1130	1210	1230	1290	1310	1390	1410	1250	1270	1350	1370	1450	1470	
Pr(S)	200															

Note: All unlabeled dimensions are in millimeters



BF200 Pro



#### ARD

If the lift power off, The ARD device will provide the power to make lift levelling and release the user leaving away from lift safely.



#### Safety Protection Device

European Safety Protection: Imported magnetic scale absolute positioning system + electronic safety gear (anti-fall)



#### Main Unit: French SOMETAS

- Stable performance, low noise
- Low power, low energy consumption, and energy-saving
- Light weight, compact size, and space-saving for installation
- Strong compatibility, high reliability, and maintenance-free

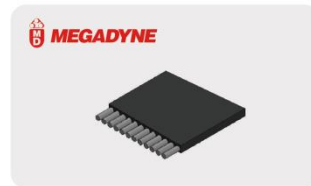

#### Belt

- Brand: MEGADYNE
- Low noise, high transmission efficiency
- High flexibility, reducing vibration during elevator operation
- Easy maintenance, no oil contamination



# SPECIFICATION

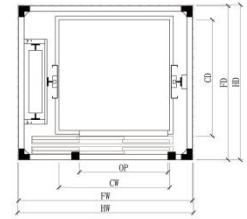
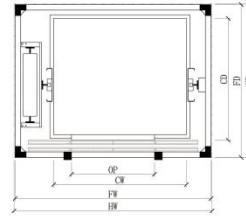

Model	BF220 Pro						BF230 Pro									
Shaft type	Aluminum frame															
Machine position	left/right top-mounted															
Operating speed(m/s)	0.4/0.63															
Opening type	Center opening door						Side opening door									
NO.	1	2	3	4	5	6	7	8	9	10	11	12				
Person	4-5			5-6			3-4			4-5						
Area(m <sup>2</sup> )	L			XL			M			L						
	0.9-1.2			1.2-1.6			0.7-0.9			0.9-1.2						
load(KG)	320			400			250			320						
Car width(CW)	1000		1100		1200		1300		800		900		1000		1100	
Car depth(CD)	900	1000	900	1000	1000	1000	1000	900	900	900	1000	1000	900	1000	900	1000
Car high(CH)	2200 <sup>(high:2100)</sup>															
Door opening width(OP)	650		700		750		800		650		700		750		800	
Door opening height(OPH)	2000															
Overhead(OH)	2900															
Shaft width(HW)	1590		1690		1790		1890		1390		1490		1590		1690	
Shaft depth(HD)	1190	1290	1190	1290	1290	1290	1290	1250	1250	1250	1350	1250	1250	1350	1250	1350
Frame width(FW)	1570		1670		1770		1870		1370		1470		1570		1670	
Frame depth(FD)	1180	1280	1180	1280	1280	1280	1280	1240	1240	1240	1340	1240	1240	1340	1240	1340
PR(S)	150															

Note: All unlabeled dimensions are in millimeters

# CLASSICS 01



1 2  
Decoration are optional

## Enclosure & Ceiling



V-Stst06



V-Stst18



V-Stst20



V-Stst36



V-Stst37

# CLASSICS 02



1 2  
Decorations are optional

## Enclosure & Ceiling



V-Stst06



V-Stst18



V-Stst20



V-Stst36



V-Stst37



# EULOGIZE 01



1 2 3 4 5  
 Decoration are optional

## Enclosure & Ceiling



V-Stst06

V-Stst18

V-Stst20

V-Stst36

V-Stst37

## Enclosure & Ceiling



SK03

SK07

SK08

Alcantara03

Alcantara09

AlcantaraP01



# EULOGIZE 02



1 2 3 4 5  
 Decoration are optional

## Enclosure & Ceiling



V-Stst06

V-Stst18

V-Stst20

V-Stst36

V-Stst37

## Enclosure & Ceiling



SK03

SK07

SK08

Alcantara03

Alcantara09

AlcantaraP01

